



SOIL CULTIVATION MACHINERY

GOBLE DISC HARROW

- Strong, robust and durable body structure
- Different disc options
- Hydraulic wheels
- Hydraulically adjustable disc angles
- Extensive and experienced service network
- Spare parts availability
- 2 years of warranty



Hisarlar Tarım Makineleri

Erkunt Traktör Sanayii A.Ş.
Organize Sanayi Bölgesi Batı Hun Cad. No:2
06935 Sincan Ankara/TÜRKİYE

hisarlartarimmakineleri.com.tr
hisarlaryedekparca.com.tr



0312 267 50 00



Goble Disc Harrow

● The Hisarlar brand of goble disc harrows are towed type tillage equipment that are attached to the tractor with a draw bar. The road-work position and the disc battery angles can both be modified hydraulically. Compared to hanged type disc harrows, they require less torque.

● Hisarlar brand goble disc harrows feature battery profiles and liquid filling fittings on the main frame to increase weight as necessary.

● The working angle of both disc batteries in goble disc harrows can be changed hydraulically. The coils move at the same time and angle in the opposite direction during the adjustment, improving tillage effectiveness.



The battery shafts of Hisarlar brand disc harrows are made of 44HRC surface hardened steel.

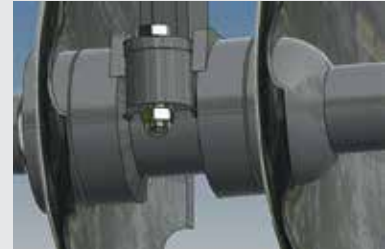

The disc bearing housings of disc harrows are maintenance-free, lubrication-free bearings.

TECHNICAL SPECIFICATIONS											
MODEL	NUMBER OF DISCS (PCS)	STATUS	HEIGHT (MM)	LENGTH (MM)	WIDTH (MM)	WORKING WIDTH (MM)	DISC DIAMETER (CM)	DISTANCE BETWEEN DISCS (CM)	CHASSIS HEIGHT (CM)	TRACTOR POWER REQUIREMENT (HP)	WEIGHT (CM)
DH 20G	20	Work	1240	5200	2520	2150	61cm standard (51cm, 56cm and 66cm optional)	11,5	65	90	1800
		Road	1460	5200	2680	-					
DH24G	24	Work	1240	5200	2950	2590	61cm standard (51cm, 56cm and 66cm optional)	11,5	65	110	1945
		Road	1460	5200	3150	-					
DH28G	28	Work	1240	5200	3360	3000	61cm standard (51cm, 56cm and 66cm optional)	11,5	65	130	2200
		Road	1460	5200	3570	-					

*Hisarlar Tarım Makineleri reserves the right to make changes to the machines without prior notice and without making changes to previously sold machines.

OPTIONAL FEATURES



Goble disc harrows have 61 cm diameter discs as standard. 51 cm, 56 cm and 66 cm diameter discs are optionally available.



Goble disc harrows have a rear draw bar linkage point. It is also possible to connect other wheeled equipment to the rear of the machine on the road. (roller group, etc)

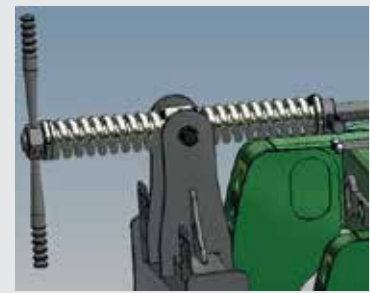

It is possible to change the angle of the draw bar and the penetration depth by means of the adjustment lever in goble disc harrows.